

LITCHFIELD, CT

MEASURED
By: PETER HAWLEY
3/18/12
peter.hawley@att.net
WWW.GREYSTONERACING.NET

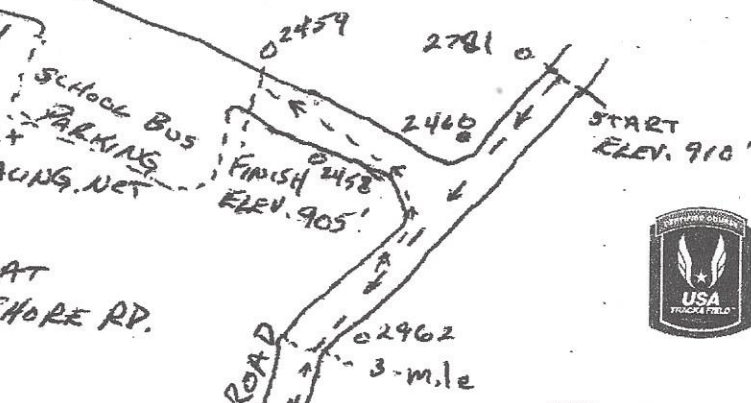

THE START IS LOCATED AT
POLE # 2781 ON NORTH SHORE RD.
PROCEED SOUTH.

THE 1-MILE IS LOCATED AT
6' SOUTH OF POLE # 3269.

THE TURN AROUND IS LOCATED
92' 3" SOUTH OF POLE # 2663.

THE 2-MILE IS LOCATED AT
2' SOUTH OF POLE # 2799.

THE 3-MILE IS LOCATED AT
44' SOUTH OF POLE # 2962.

THE FINISH IS LOCATED AT
POLE # 2459 (NEAR THE
SCHOOL BUS PARKING LOT).

CT12014JHP

Effective 3/29/2012 to 12/31/2022

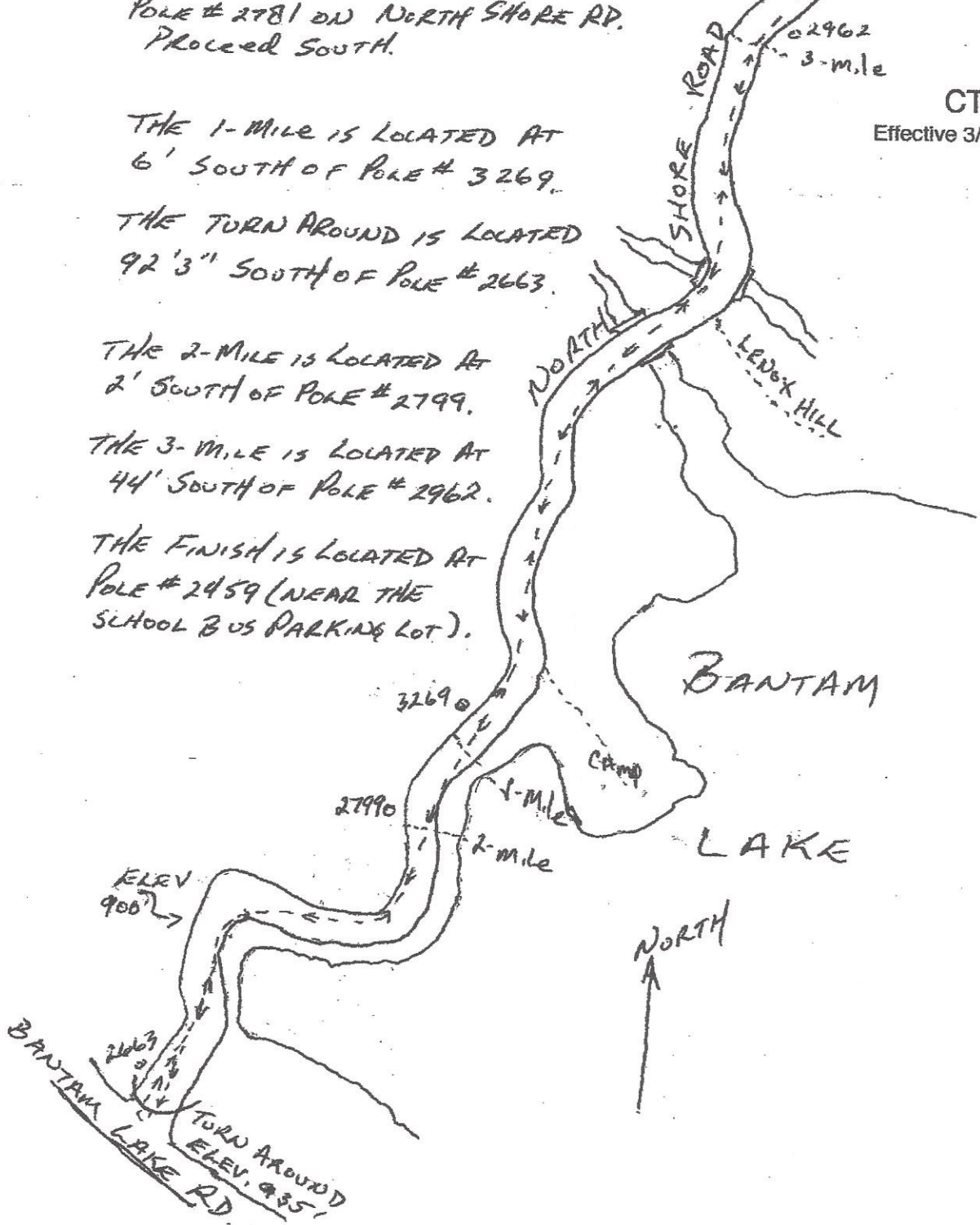

BANTAM LAKE RD
TURN AROUND
ELEV. 955'